

SKETCH/AREA TABLE ADDENDUM

Case No 1783

File No 01

SUBJECT

Property Address	706 Holbrooke Ave		
City	Wilmington	County	New Hanover
		State	NC
Zip	28412		
Borrower	Measured 1/6/2012		
Lender/Client	Scott Gregory	L/C Address	Coldwell Banker Sea Coast Realty
Appraiser Name	Jeremy T. Brant	Appr Address	Home Dimensional

IMPROVEMENTS SKETCH

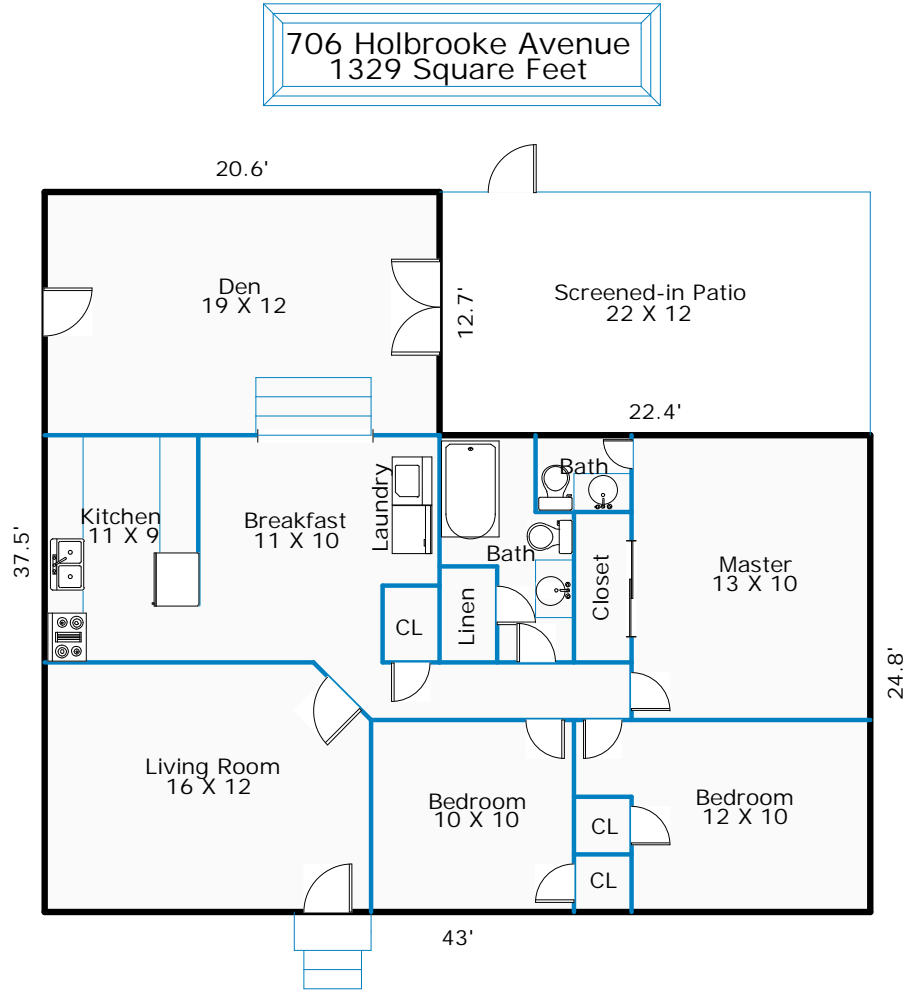

Comments:

AREA CALCULATIONS

Scale: 1 = 10

AREA CALCULATIONS SUMMARY

Code	Description	Net Size	Net Totals
GLA1	First Floor	1328.6	1328.6
Net LIVABLE Area		(rounded)	1329

LIVING AREA BREAKDOWN

Breakdown		Subtotals
First Floor		
43.0	x	24.8
12.7	x	20.6
		1067.8
		260.7
2 Items		(rounded)
		1329