

SKETCH/AREA TABLE ADDENDUM

Case No 1753

File No 01

SUBJECT

Property Address 3605 Amber Drive			
City Wilmington	County New Hanover	State NC	Zip 28409
Borrower Measured 11-14-11			
Lender/Client Scott Gregory	L/C Address Coldwell Banker Sea Coast Realty		
Appraiser Name A. Kozol	Appr Address Home Dimensional		

IMPROVEMENTS SKETCH

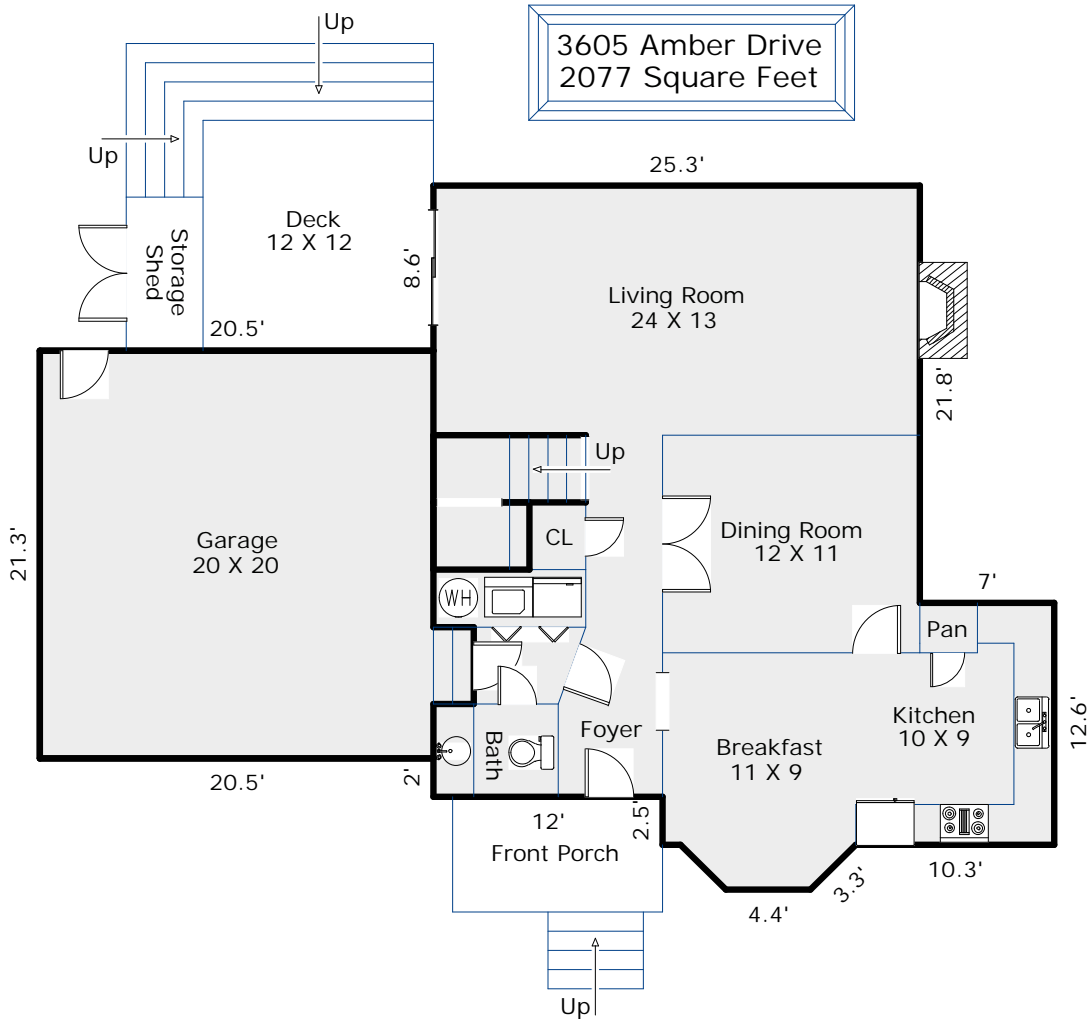

Comments:

AREA CALCULATIONS

Scale: 1 = 10

AREA CALCULATIONS SUMMARY			
Code	Description	Net Size	Net Totals
GLA1	First Floor	935.5	935.5
GAR	Garage	444.0	444.0
Net LIVABLE Area		(rounded)	936

LIVING AREA BREAKDOWN			
Breakdown			Subtotals
First Floor			
	45.8	x	13.2
	8.6	x	25.3
	52.8	x	8.1
0.5	2.4	x	2.4
	2.5	x	20.4
	2.0	x	32.3
	4.4	x	2.4
0.5	2.4	x	2.4
Garage			-444.0
8 Items			(rounded)
			936

SKETCH/AREA TABLE ADDENDUM

Case No 1753

File No 01

SUBJECT

Property Address 3605 Amber Drive			
City Wilmington	County New Hanover	State NC	Zip 28409
Borrower Measured 11-14-11			
Lender/Client Scott Gregory	L/C Address Coldwell Banker Sea Coast Realty		
Appraiser Name A. Kozol	Appr Address Home Dimensional		

IMPROVEMENTS SKETCH

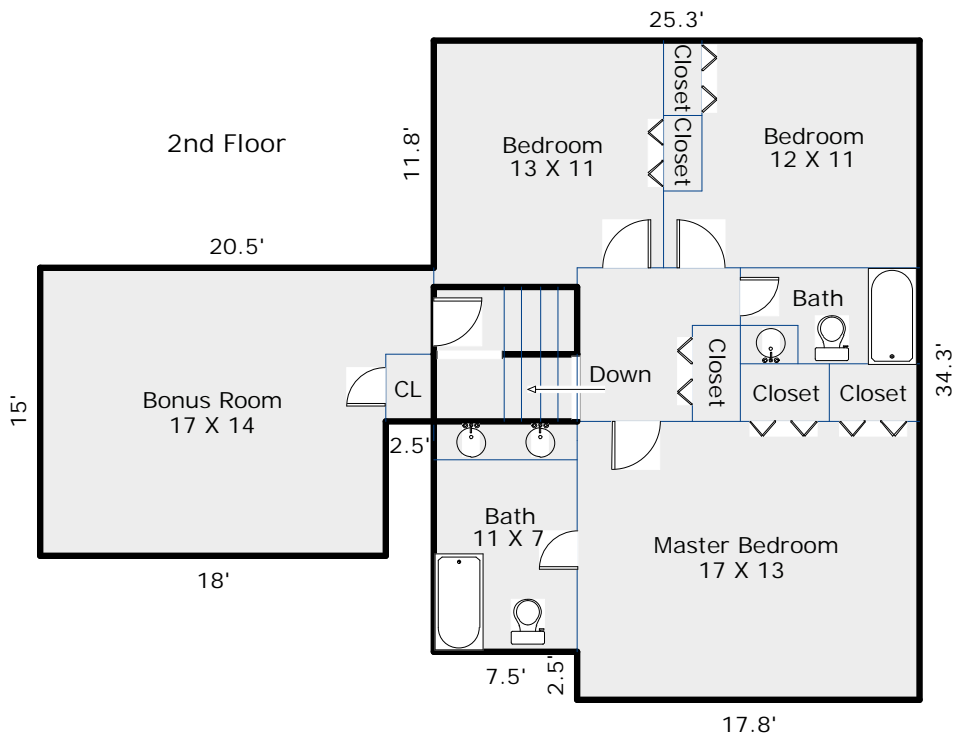

Comments:

AREA CALCULATIONS

Scale: 1 = 10

AREA CALCULATIONS SUMMARY			
Code	Description	Net Size	Net Totals
GLA2	Second Floor	1141.0	1141.0
Net LIVABLE Area		(rounded)	1141

LIVING AREA BREAKDOWN			
Breakdown			Subtotals
Second Floor			
25.3	x	11.8	299.8
2.5	x	17.8	44.6
12.0	x	25.3	304.0
7.0	x	18.0	126.0
8.0	x	45.8	366.7
5 Items			(rounded)
			1141