

SKETCH/AREA TABLE ADDENDUM

Case No 1782

File No 01

SUBJECT

Property Address	1911 Prestwick Lane		
City	Wilmington	County	New Hanover
		State	NC
Zip	28405		
Borrower	Measured 1/6/2012		
Lender/Client	Scott Gregory	L/C Address	Coldwell Banker Sea Coast Realty
Appraiser Name	Jeremy T. Brant	Appr Address	Home Dimensional

IMPROVEMENTS SKETCH

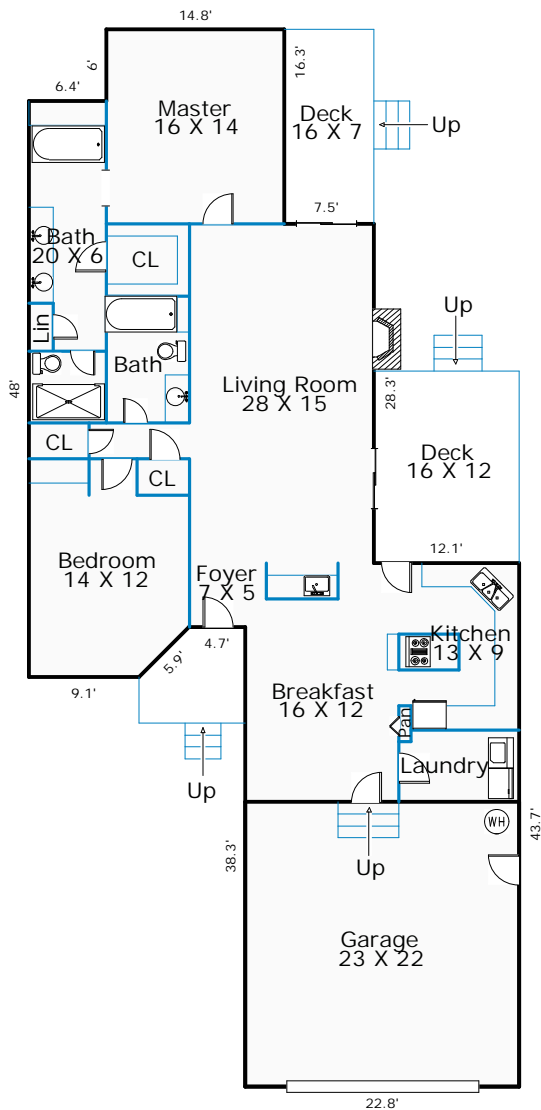

1911 Prestwick Lane
1717 Square Feet

Comments:

AREA CALCULATIONS

Scale: 1 = 16

AREA CALCULATIONS SUMMARY			
Code	Description	Net Size	Net Totals
GLA1	First Floor	1716.6	1716.6
GAR	Garage	542.3	542.3
Net LIVABLE Area		(rounded)	1717

LIVING AREA BREAKDOWN			
		Breakdown	Subtotals
First Floor			
	4.2 x	9.1	38.1
	6.0 x	14.8	89.0
	10.3 x	21.3	217.8
	28.3 x	28.8	812.2
	38.3 x	22.8	875.3
	5.3 x	40.8	217.8
0.5 x	4.2 x	4.2	8.8
Garage			-542.3
7 Items		(rounded)	1717