

SKETCH/AREA TABLE ADDENDUM

Case No 1689

File No 01

SUBJECT

Property Address 1007 S 11th Street			
City Wilmington	County New Hanover	State NC	Zip 28401
Borrower Measured 8-9-11			
Lender/Client Scott Gregory	L/C Address Coldwell Banker Sea Coast Realty		
Appraiser Name A. Kozol	Appr Address Home Dimensional		

IMPROVEMENTS SKETCH

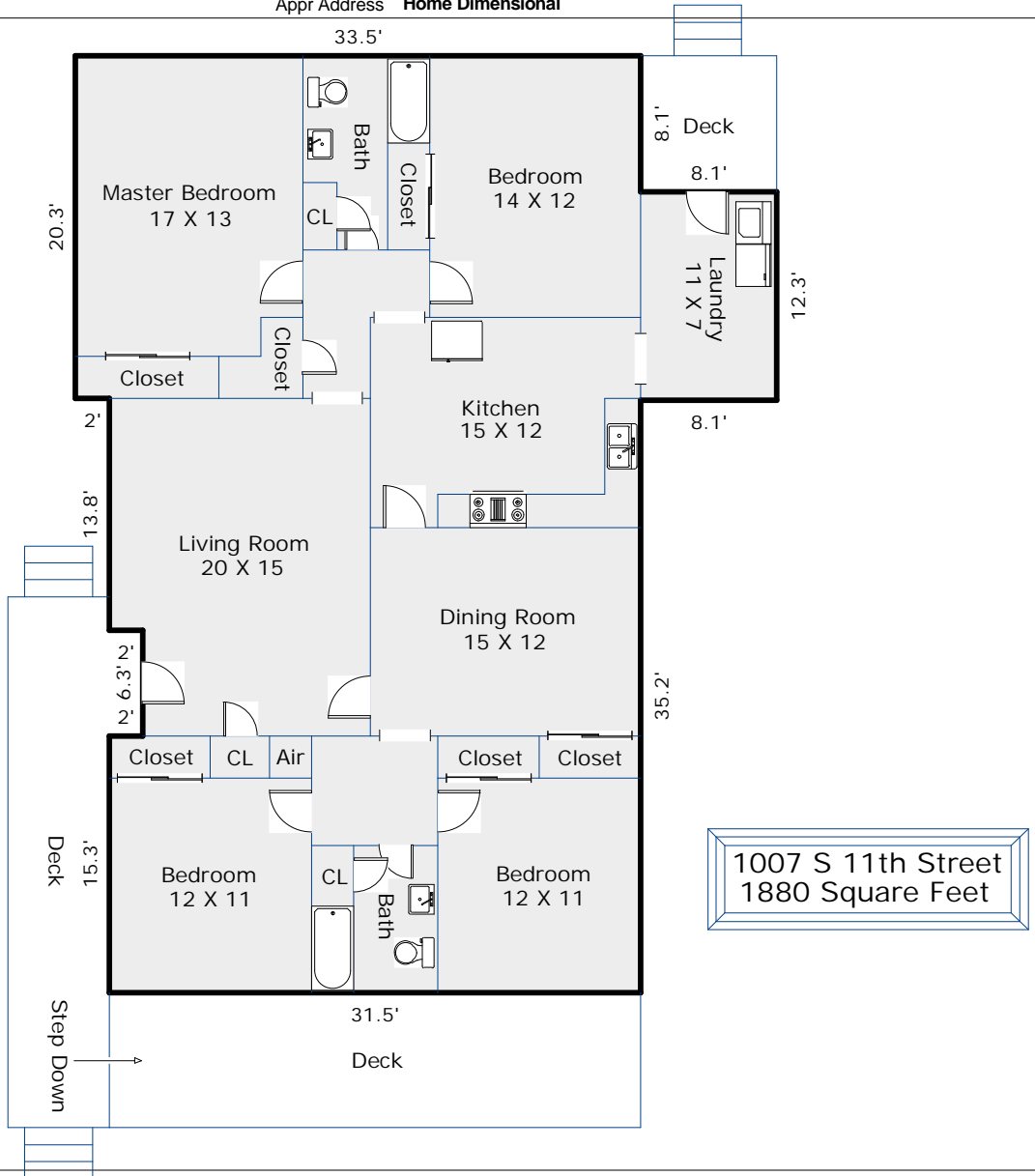

Comments:

AREA CALCULATIONS

Scale: 1 = 11

AREA CALCULATIONS SUMMARY

Code	Description	Net Size	Net Totals
GLA1	First Floor	1878.7	1878.7
Net LIVABLE Area		(rounded)	1879

LIVING AREA BREAKDOWN

Breakdown			Subtotals
First Floor			
31.5	x	15.3	480.4
6.3	x	29.5	184.4
31.5	x	13.7	430.5
41.6	x	12.3	509.4
0.1	x	39.6	3.3
8.1	x	33.5	270.8
6 Items		(rounded)	1879